

30° Roof Pitch

Fixing in accordance with the
manufacturers printed instructions,
BS5534 part 1 2003, BS8000 part 6
1990 and H61/210 and 275

Copper Disc Rivets & Nails
to BS5534 part 1 2003

Counter Batten

Continuous Ventilated Fibre Cement Ridge

Airpath

Airpath

LR Underlay
(Breather Membrane)

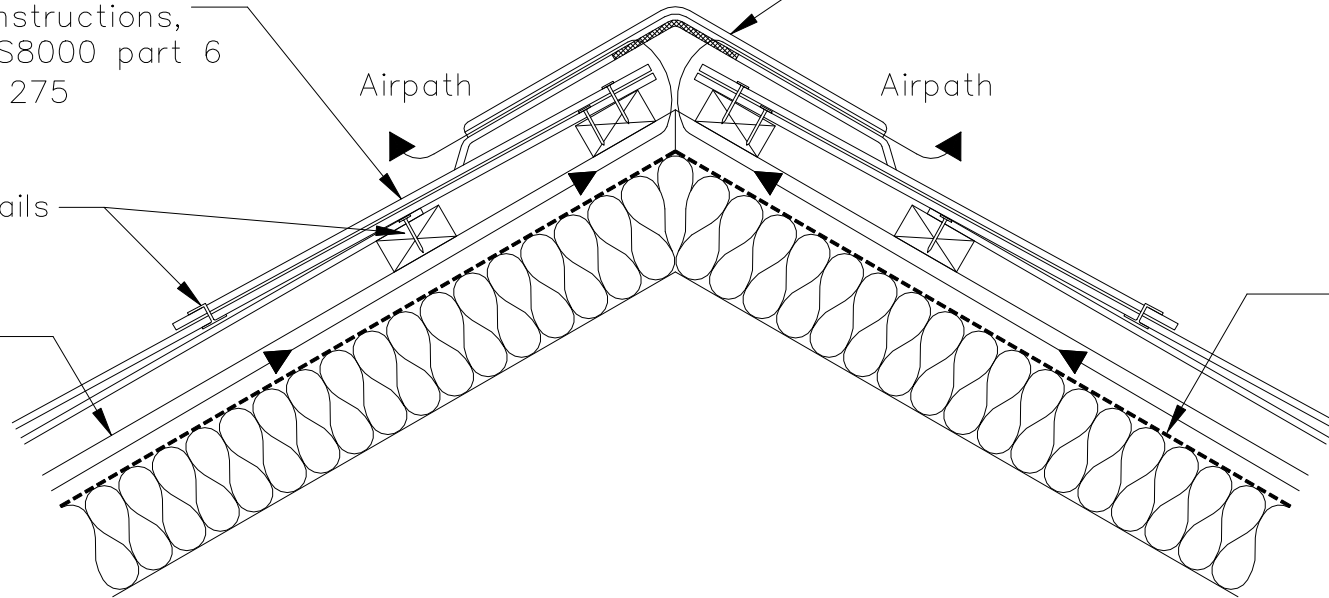

CEMBRIT LIMITED
INSULATION AT RAFTER LEVEL (WARM ROOF)
VENTILATED FIBRE CEMENT RIDGE TYPICAL DETAIL
600x300 JUTLAND (FIBRE CEMENT) SLATE
DRG No. 235 H61/110 and 705